

Elevator Weighing Kit – Under Springs

LEWS-xt-X-xA2-E

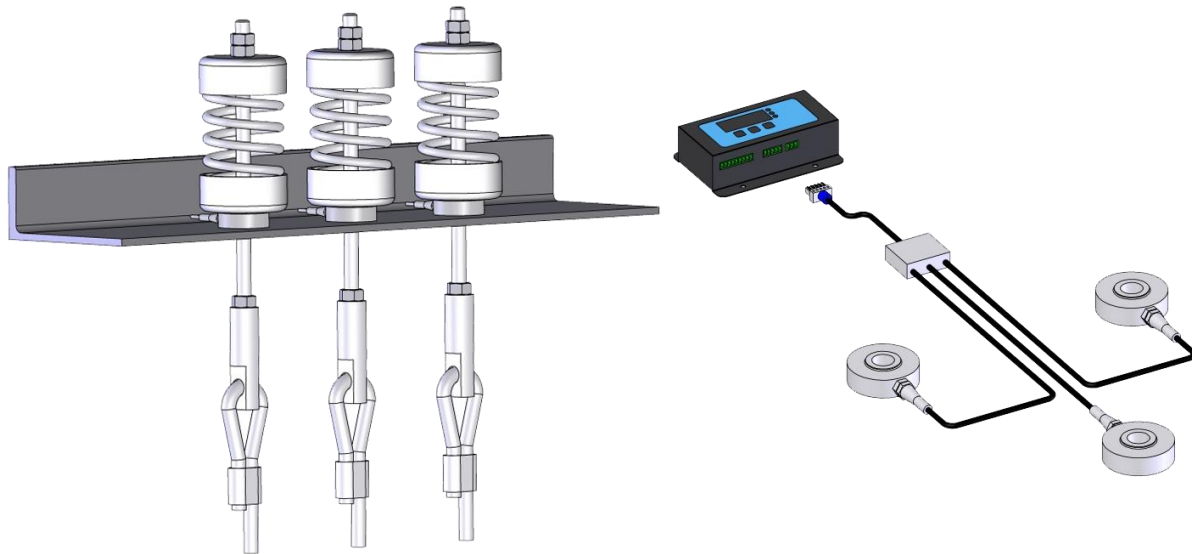

Short Description



- 2 / 3* / 4 / 6 Aluminium IP65 compression load cells
- Pre-calibrated IP54 indicator
- High accuracy
- Durable design
- Suitable for elevator weighing
- Easy installation, plug & play
- Indicates when elevator is loaded for 90% of the capacity
- Determines if the elevator is overloaded
- When less than 15 kg is loaded, the elevator doesn't move
- Adjusts engine power to actual weight

Set Contains

Quantity	Capacity	Full Article Description
2 / 3* / 4 / 6	1t	L2H-45-1t-0.3B Load cell
1		IP65 fully potted Junction box
1		Top-Sensors HC51x Indicator

* Set with 3 loadcells is the standard version. Sets with other load cell quantities available upon request.

Specifications and dimensions are subject to change without notice and do not constitute any liability whatsoever.



Technical Specifications L2H-45-1t-0.3B

Accuracy Class		G5
Output Sensitivity (= FS)	mV/V	1.0 ± 0.2
Maximum Capacity (E _{max})	t	1
Max. Number of Load Cell Intervals	n _{LC}	3000
Ratio of min. LC Verification Interval	$Y = E_{max} / V_{min}$	10000
Combined Error	%FS	≤± 0.5
Creep Error (5 minutes)	%FS	≤± 0.5
Non-Linearity	%FS	≤± 1.0
Repeatability	%FS	≤± 1.0
Hysteresis	%FS	≤± 1.0
Temperature Effect on Zero (ZTC)	%FS/10°C	≤± 0.3
Temperature Effect on Sensitivity (STC)	%FS/10°C	≤± 0.3
Zero Balance	%FS	≤± 0.1
Safe Overload	of E _{max}	120%
Ultimate Overload	of E _{max}	150%
Excitation, Recommended Voltage	V	5 ~ 10
Excitation, Maximum Voltage	V	12
Input Resistance	Ω	350 ± 50
Output Resistance	Ω	350 ± 50
Insulation Resistance (50V)	MΩ	≥5000
Compensated Temperature	°C	-10 ~ + 40
Operating Temperature	°C	-35 ~ + 65
Storage Temperature	°C	-40 ~ + 70
Load Cell Weight	kg	0.3
Element Material		Aluminium
Ingress Protection (acc. to EN 60529)		IP65

Wiring

Features:

Cable type: Shielded, 4 conductor cable
 Cable diameter: Ø 3.8mm
 Cable length: 0.3m ± 0.01m
 Cable jacket: PVC
 Shield not connected to element

4-Wire Connection Diagram

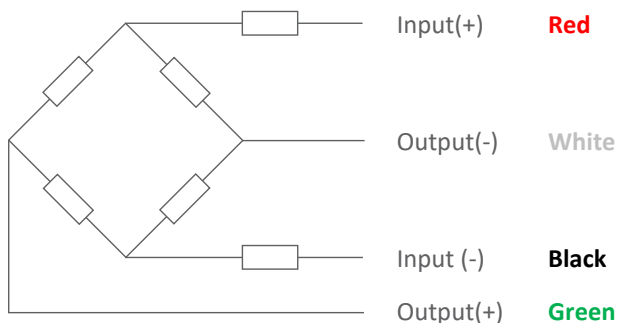

Specifications and dimensions are subject to change without notice and do not constitute any liability whatsoever.

Elevator Weighing Kit – Under Springs

LEWS-xt-X-xA2-E

Dimensions in mm

Top View

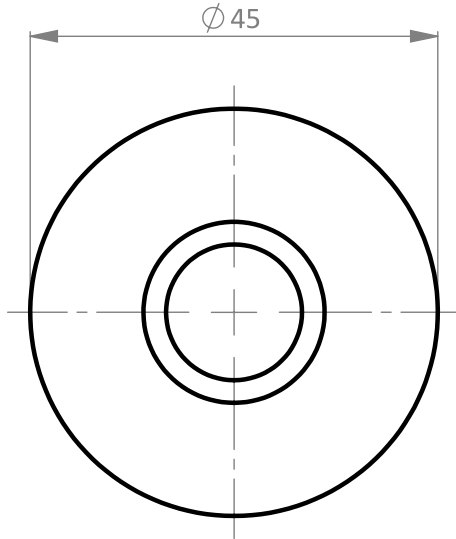

Bottom View

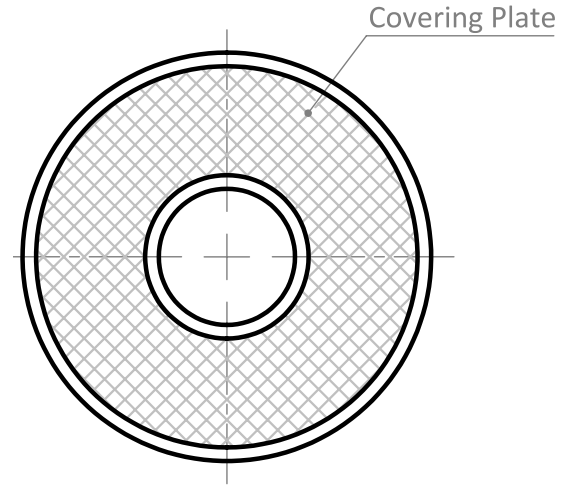

Side View

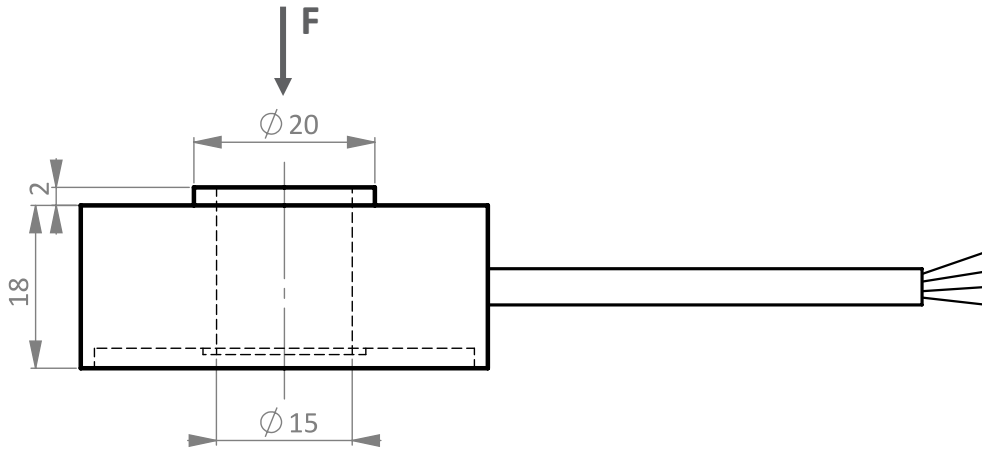

Isometric View

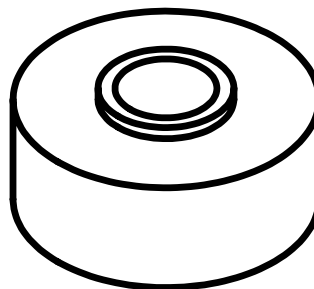

Elevator Weighing Kit – Under Springs

LEWS-xt-X-xA2-E

Technical Features Top-Sensors HC51x Indicator

Power Supply	HC510: 230VAC ± 10% / 50~60 Hz	HC512: 24VDC ± 10%		
Power Consumption	6 W (max.)			
Maximum Current Switched by Relay Outputs	10 A / 28VDC			
Operating Mode	continuous			
Number of Programmable Relay Outputs	3			
Setting Threshold Range Loading	Set in kg			
Passenger Availability	0-50 kg			
90%	0-2000 kg	0-3000 kg	0-4000 kg	0-6000 kg
110%	0-2000 kg	0-3000 kg	0-4000 kg	0-6000 kg
Maximum Load	Sum of individual loadcells			
Maximum Permissible Short-time Overload	150%			
Lower Limit of Transformations	5 kg			
Maximum Duration of the Conversion Cycle	2 seconds			
Display	4-digit LED, 14.2mm 7-segment			
Indicators	Overload, Caution, Pre-caution			
Keypad	3-key flat tactile switches			
Operating Temperature Range	-10 ~ +40°C			
Storage Temperature Range	-20 ~ +50°C			
Humidity	0 ~ 90% @ 20°C (rel.)			
Degree of Protection for IEC 60529 (DIN 40050)	IP54			
Indicator Net Weight	0.60kg			

Indicator Connection Diagram

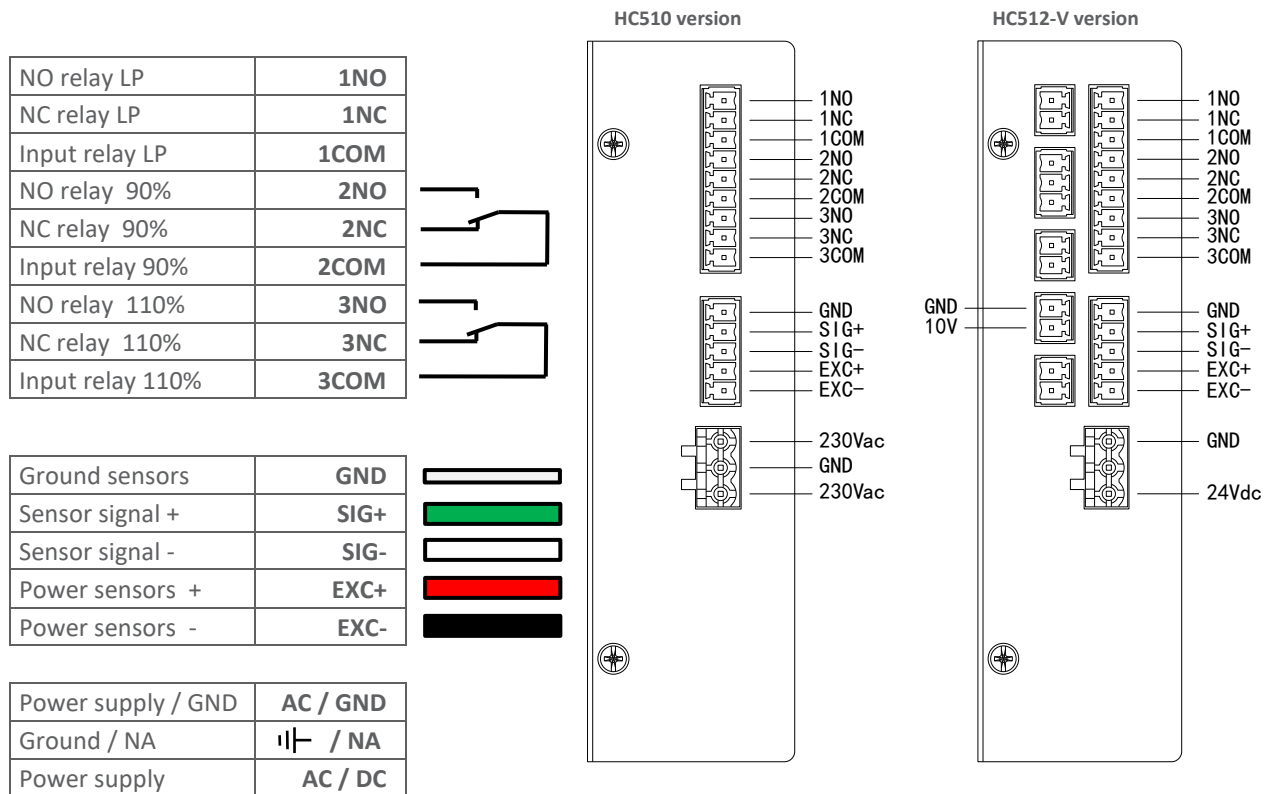

Elevator Weighing Kit – Under Springs

LEWS-xt-X-xA2-E

Indicator Dimensions in mm

Top View

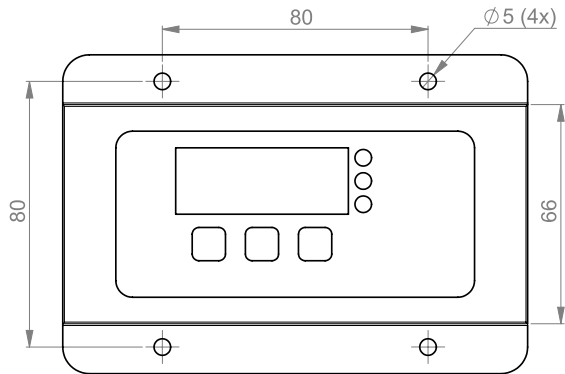

Side View

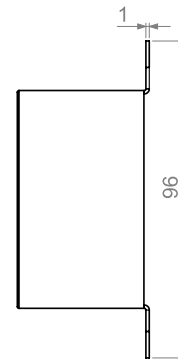



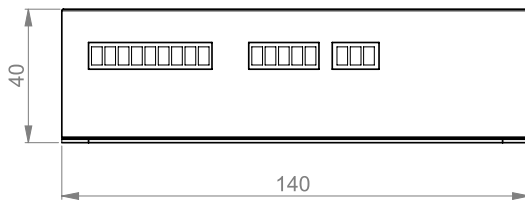



Front View



Display Keys and Settings



Indicator	Status	Key	Functions
 110%	LED Overload		Reset button / Scroll parameter / Increase value
 90%	LED 90% Load		Select a digit / Scroll menu
 	LED Child only in elevator		Turn on and off the display / Enter

Specifications and dimensions are subject to change without notice and do not constitute any liability whatsoever.